



Intermot Hydraulic Motors

Disk Brakes – F Series

TECHNICAL CATALOGUE

INDEX

| | |
|--------------|--------|
| F21R – F21DR | Pag. 3 |
| F80 – F80S | Pag. 7 |

Disk Brakes – F Series – Technical data

F21R
F21DR

| Brake Model Modello Freno | F21R | F21DR |
|--|----------------------|----------------------|
| Static torque * Coppia statica* | 1800 Nm | 1800 Nm |
| Minimum complete opening pressure ** Pressione minima di apertura completa ** | 35 bar | 35 bar |
| Maximum pressure on the cylinder Pressione massima sul cilindro | 60 bar | 60 bar |
| Dry mass Massa a secco | 26,3 kg | 33,6 |
| Lubrication oil quantity Quantità olio lubrificante | 450 cm ³ | 450 cm ³ |
| Pilot oil quantity Quantità olio di pilotaggio | 65,1 cm ³ | 65,1 cm ³ |

*Considered with internal pilot pressure at 0 bar

*Considerata con pressione di pilotaggio 0 bar all'interno del freno

** Available also with higher opening pressure, with less oil quantity

** Disponibile anche con pressione di apertura maggiorata e ridotta quantità di olio di pilotaggio

Disk Brakes – F Series – Technical data

F21R

F21DR



Braking torque in function of the number of brake disk springs.
The standard version is supplied with 19 springs.

Coppia frenante in funzione del numero di molle spingi disco.
La versione standard viene fornita con 19 molle.

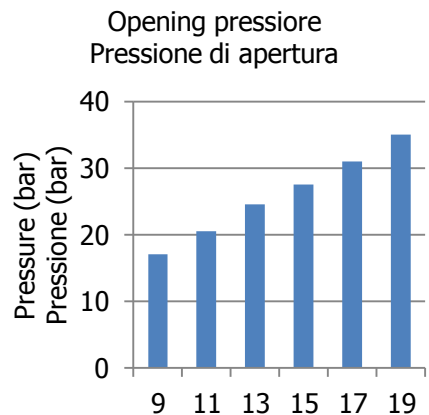
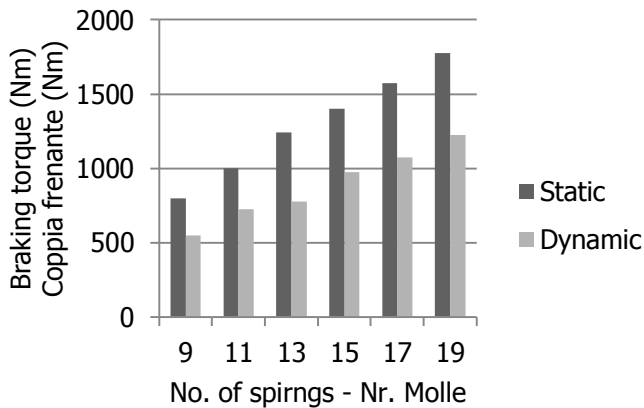

Dimensional drawings

F21R

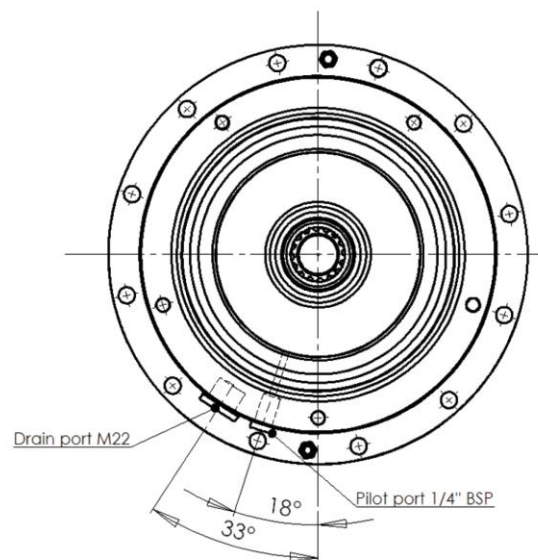
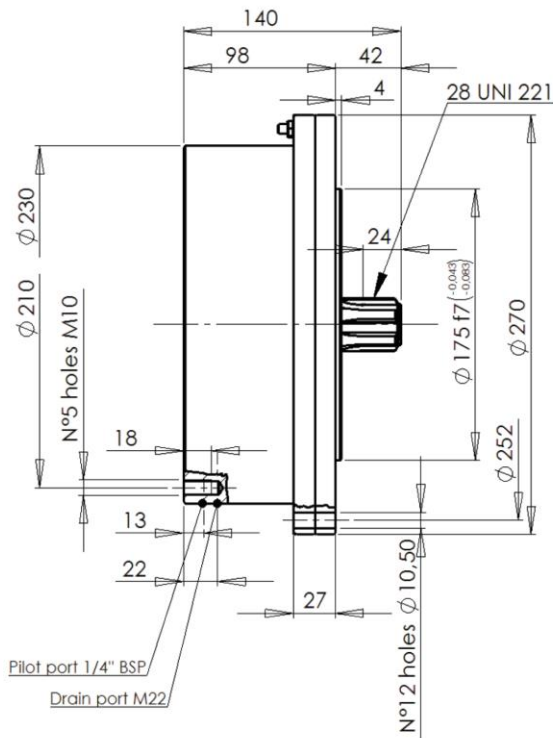

SPLINED DATA 28 UNI 221

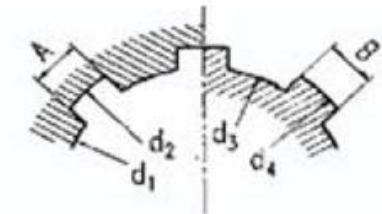

| | | | |
|-------|-------|------------------|-----|
| d_1 | Ø28.0 | +0.021 +0 | H7 |
| d_2 | Ø34.1 | +0.160 +0 | H11 |
| A | 7.0 | +0.028 +0.013 | F7 |
| d_3 | Ø28.0 | -0.007 -0.020 | g6 |
| d_4 | Ø34.0 | -0.065 -0.160 | h14 |
| B | 7.0 | -0.013 -0.028 | f7 |

F21DR

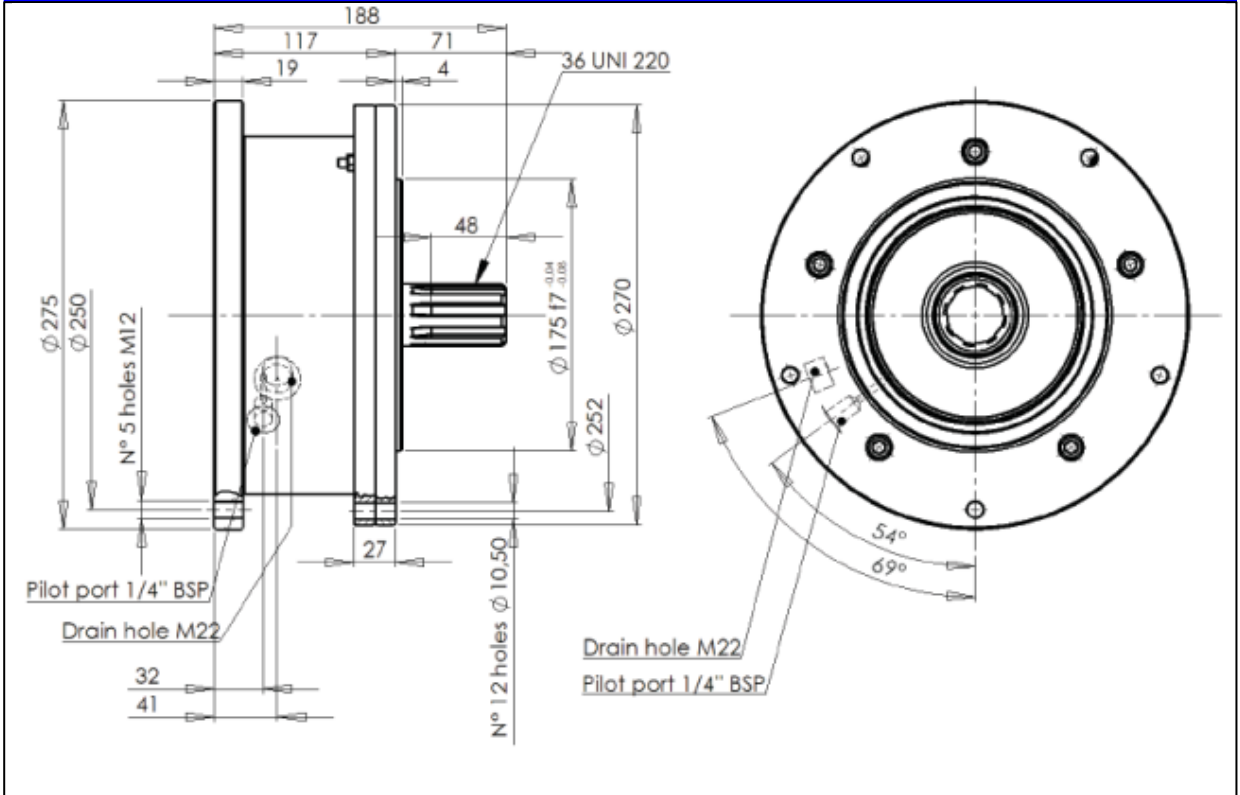

SPLINED DATA 36 UNI 221

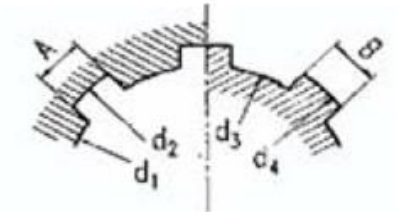

| | | | |
|-------|--------------------|----------------------|-----|
| d_1 | $\varnothing 36.0$ | $+0.025$ $+0$ | H7 |
| d_2 | $\varnothing 40.0$ | $+0.160$ $+0$ | H11 |
| A | $\varnothing 7.0$ | $+0.028$ $+0.013$ | F7 |
| d_3 | $\varnothing 36.0$ | -0.009 -0.025 | g6 |
| d_4 | $\varnothing 40.0$ | -0.065 -0.160 | d11 |
| B | $\varnothing 7.0$ | -0.013 -0.028 | f7 |

Disk Brakes – F Series – Technical data

F80



| Brake Model Modello Freno | F80S 22 SPRINGS | F80S 15 SPRINGS |
|--|----------------------------|----------------------------|
| Static torque * Coppia statica* | 8000 Nm | 1800 Nm |
| Minimum complete opening pressure ** Pressione minima di apertura completa ** | 35 bar | 12 bar |
| Maximum pressure on the cylinder Pressione massima sul cilindro | 60 bar | 60 bar |
| Dry mass Massa a secco | 70 kg | 70 kg |
| Lubrication oil quantity Quantità olio lubrificante | 1200 cm ³ | 1200 cm ³ |
| Pilot oil quantity Quantità olio di pilotaggio | 70,8 cm ³ | 70,8 cm ³ |

*Considered with internal pilot pressure at 0 bar

*Considerata con pressione di pilotaggio 0 bar all'interno del freno

** Available also with higher opening pressure, with less oil quantity

** Disponibile anche con pressione di apertura maggiorata e ridotta quantità di olio di pilotaggio

F80 / F80S

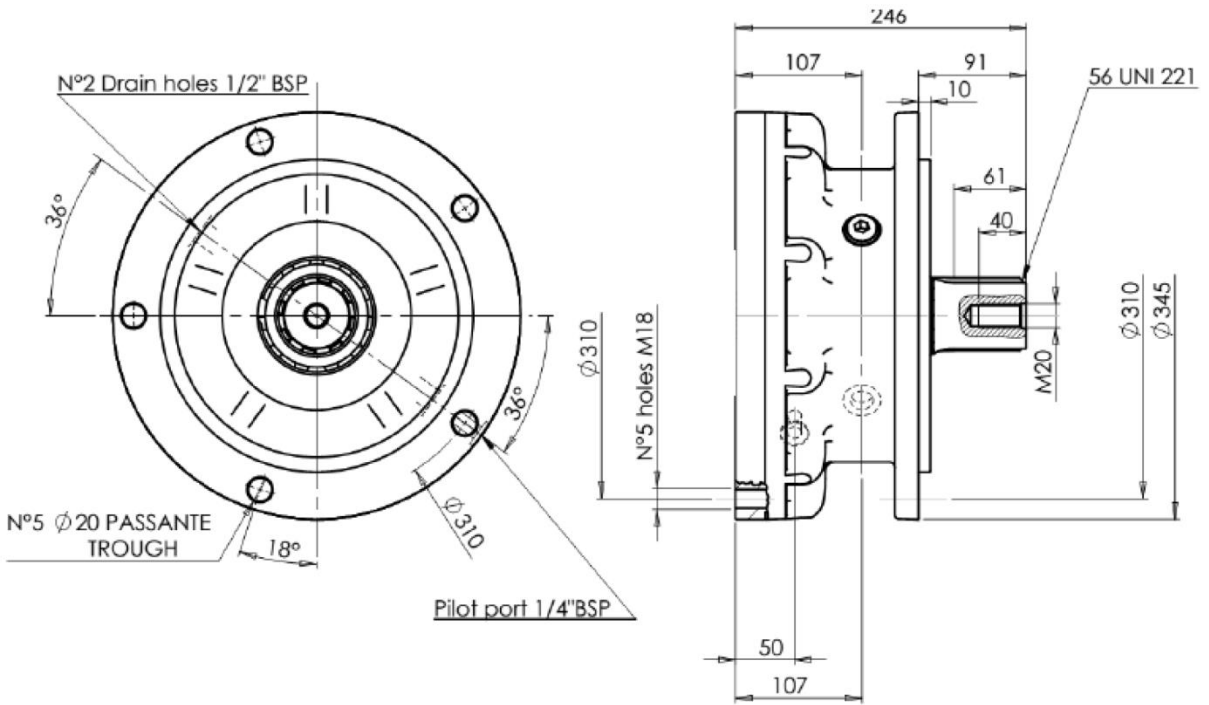

SHAFTS

A0: Splined shaft
56 UNI 221

A1: Internal splined shaft
55x3x17 DIN 5480

A2: Parallel shaft

